

SURVEYOR'S RECORD

Section 26

Township 106

Range 40

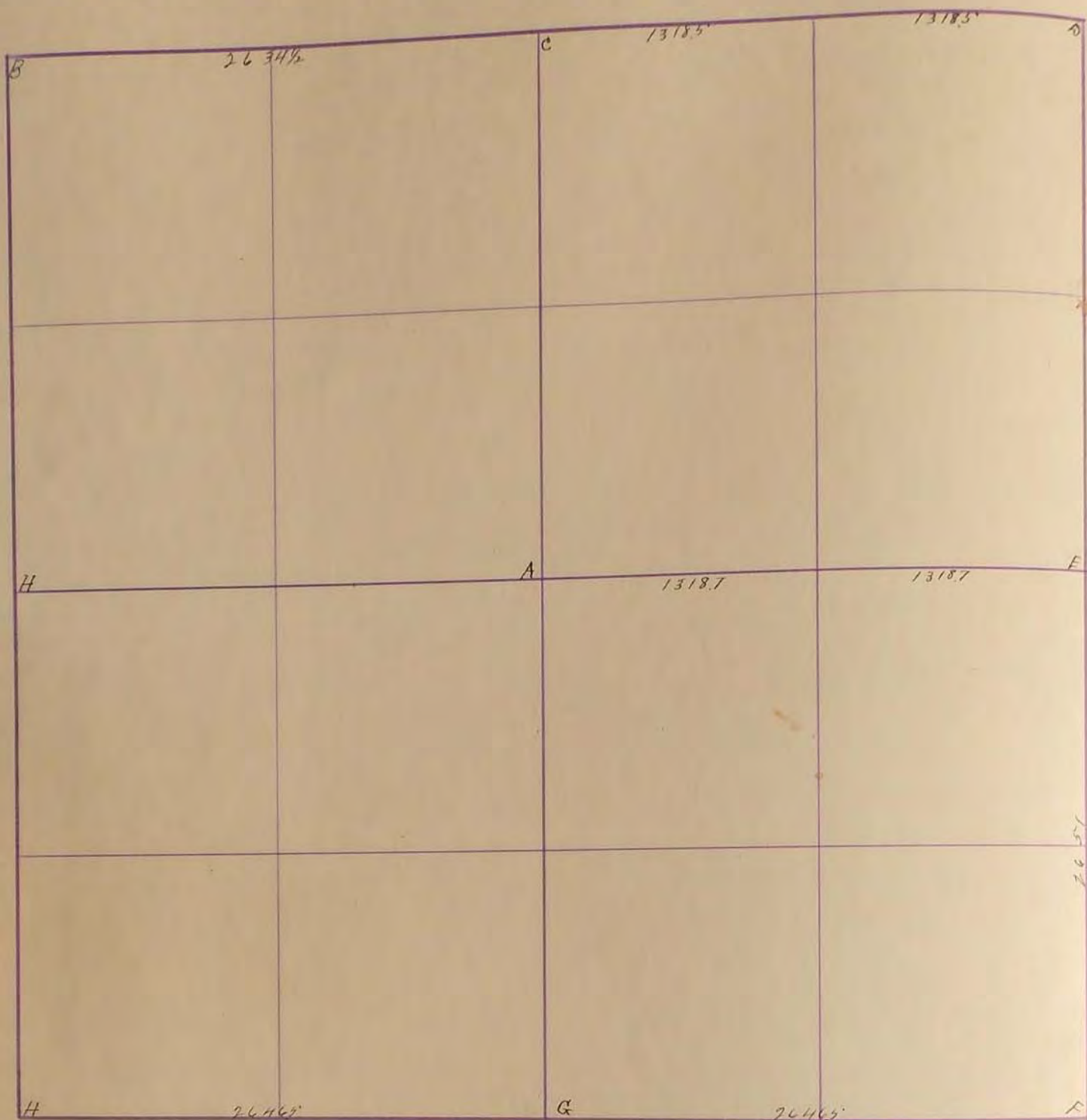

Aug. 26 1902

- A. Stone 14X16X16 (gray)
- B. .. 12X14X16 ..
- C. .. 12X12X14 ..
- D. Sov. mound; pits & stake
- E.
- F. Stone 8X6X16 gray
- G. .. 10X10X14 ..
- H. See Sec. 27
- I.

J. H. Hasletine

"F" Concrete Stone: R.P. Tack in Cor fence post NE 48°

R.P. Tack in Cor fence post SE 48°

"G" Concrete Stone: R.P. Edge of Steel Cor post North 34°

R.P. Edge of Rnd Steel post N.W. 49°

~~"G" located 2 1/2" Hub 8" below oil mat. Placed 5/8" steel pin above R.P. N&S. Brass post N. 52.01'; R.P. N&S. Fence post N/W 54.76'~~

~~"F" located steel pin @ surface of oil mat. R.P. N&S. Tol. Brass pole N/E 12.80'; R.P. N&S. Cor. Post N/W 51.51'~~

"G" Placed 18" Conc. Monu. with Iron pin in center 4" below Gravel surface. R.P. N&E in R.P. N. 59.85° Chisled "x" on Culv. End SW 69.80-NW 70.85. "F" Placed 18" Conc. Monu. with Iron pin in center 4" below Gravel surface. R.P. N&E in R.P. NW 51.51° Nails in Road N+ S. 100' + 200'

26
27

SURVEY No. _____

Section 26

Town 106

Range 40

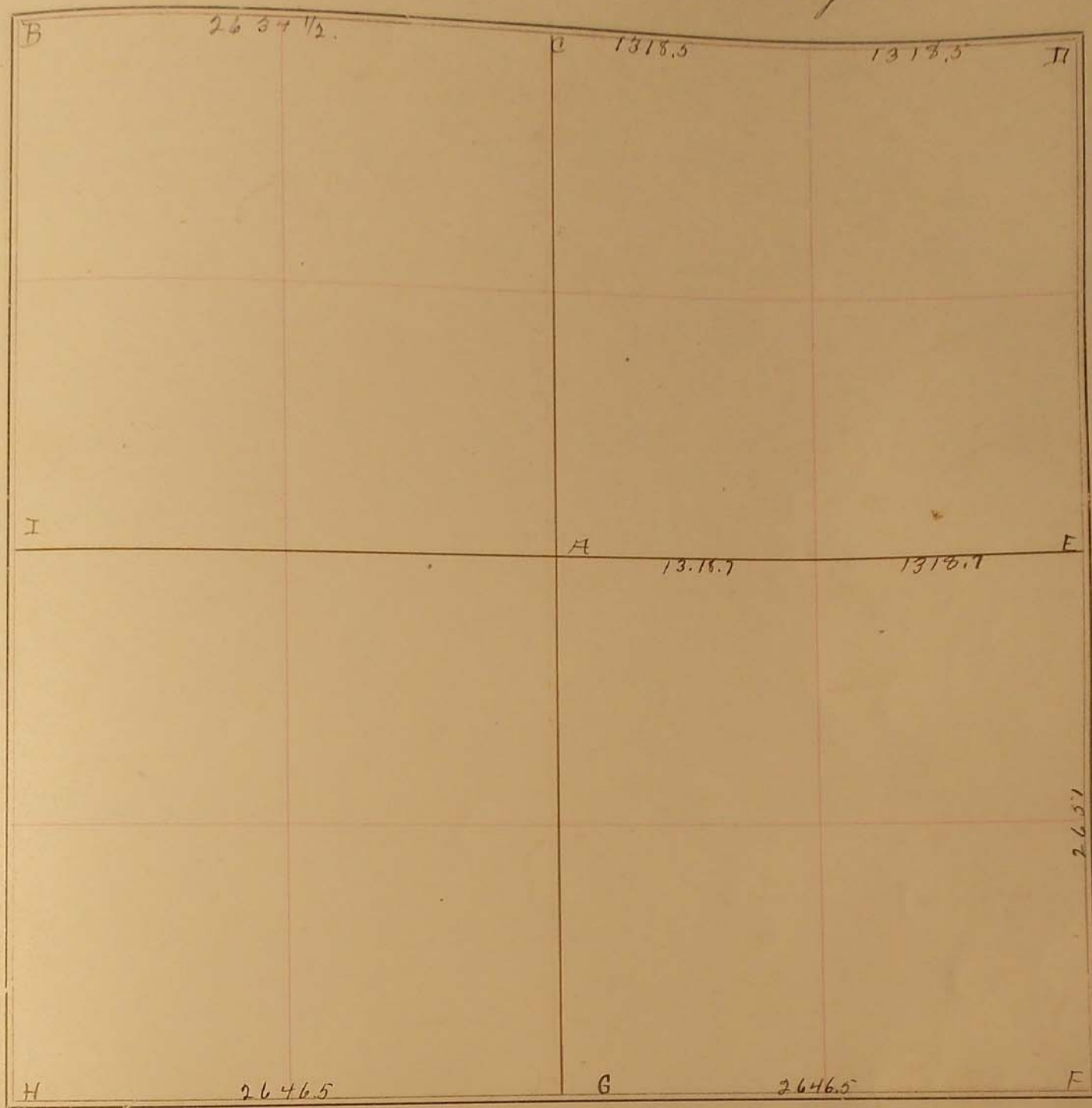

FIELD NOTES.

Aug. 26, 1902.

- A Stone 14x16x16 (grey)
- B " 12x14x16 "
- C " 12x12x14 "
- II Gov. mound + pits + stake
- E " " " "
- F Stone 5x6x16 (grey)
- G " 10x10x14 "
- H See Sec 27
- I " " "

J. W. Woolstenhulme